

These drawings and specifications are the property of H2W Technologies, Inc. They are issued in confidence and shall not be reproduced, copied, or used without written permission from H2W Technologies, Inc. (www.h2wtech.com)

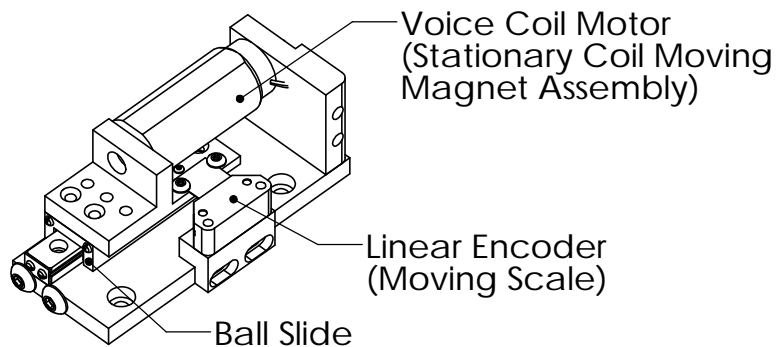
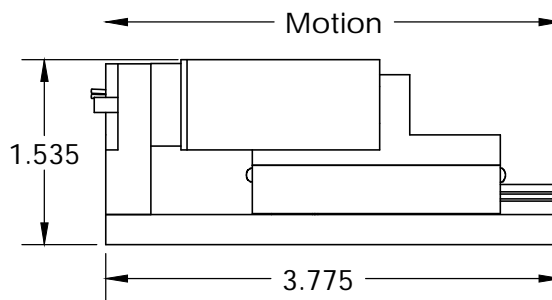
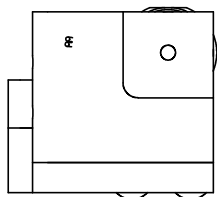
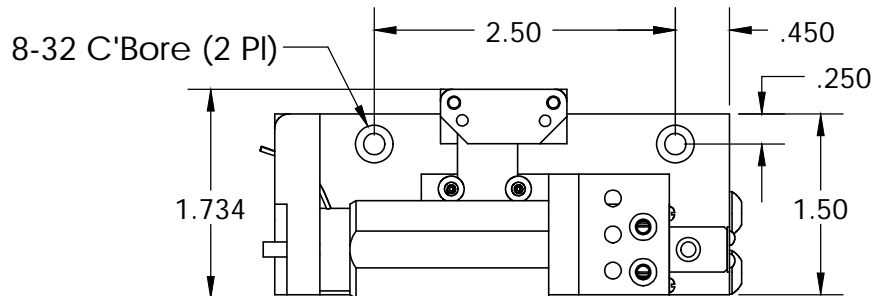

**H2W Technologies, Inc.**  
 26470 Ruether Ave #102 Santa Clarita, CA 91350 USA  
 Tel: (661) 251-2081 Fax: (661) 251-2067  
 www.h2wtech.com

UNLESS SPECIFIED OTHERWISE: All dimensions are in inches Standard Tolerances are as follows: .XXX ±.005 ANGLES ±1° .XX ±.010 FILLETS .010 .X ±.020 CORNERS .010 Remove All Burrs and Sharp Edges				<b>MATERIAL</b>		<b>TITLE</b>	
				<b>FINISH</b>		Voice Coil Positioning Stage <b>Model #: VCS06-005-BS-12</b>	
<b>DRAWN</b> OOG	<b>DATE</b> 8-22-05	<b>APPROVED</b> MPW	<b>DATE</b> 8-22-05	<b>DWG #</b> <b>30-0426</b>	<b>REV</b> ---	<b>SHEET</b> 1 of 2	

<b>VOICE COIL POSITIONING STAGE SPECIFICATIONS</b>		
Motor P/N	NCC06-08-005-2X	
Stroke	0.60"	15.2 mm
Encoder Resolution	1 micron	
Bearing Type	Ball Slide	
Moving Mass	0.24 LBS	109 grams
Total Mass	0.5 LBS	230 grams
Resistance @ 20C	3.0 ohms	
Inductance @ 20C	0.60 mH	
Electrical Time Constant	0.20 msec	
Motor Constant	0.50 LBS/SQRT(Watt)	2.23 N/SQRT(Watt)
Force Constant	0.87 LBS/Amp	3.85 N/Amp
Back EMF	0.10 V/ips	3.85 V/m/sec
Continuous Force	0.85 LBS	3.78 N
Max Power @ 100% Duty	3 Watts	
Peak Force	2.55 LBS	11.35 N
Max Power @ 10% Duty	26 Watts	

TITLE		
Voice Coil Positioning Stage Model #: VCS06-005-BS-12		
DWG #	REV	SHEET
30-0426	---	2 of 2